

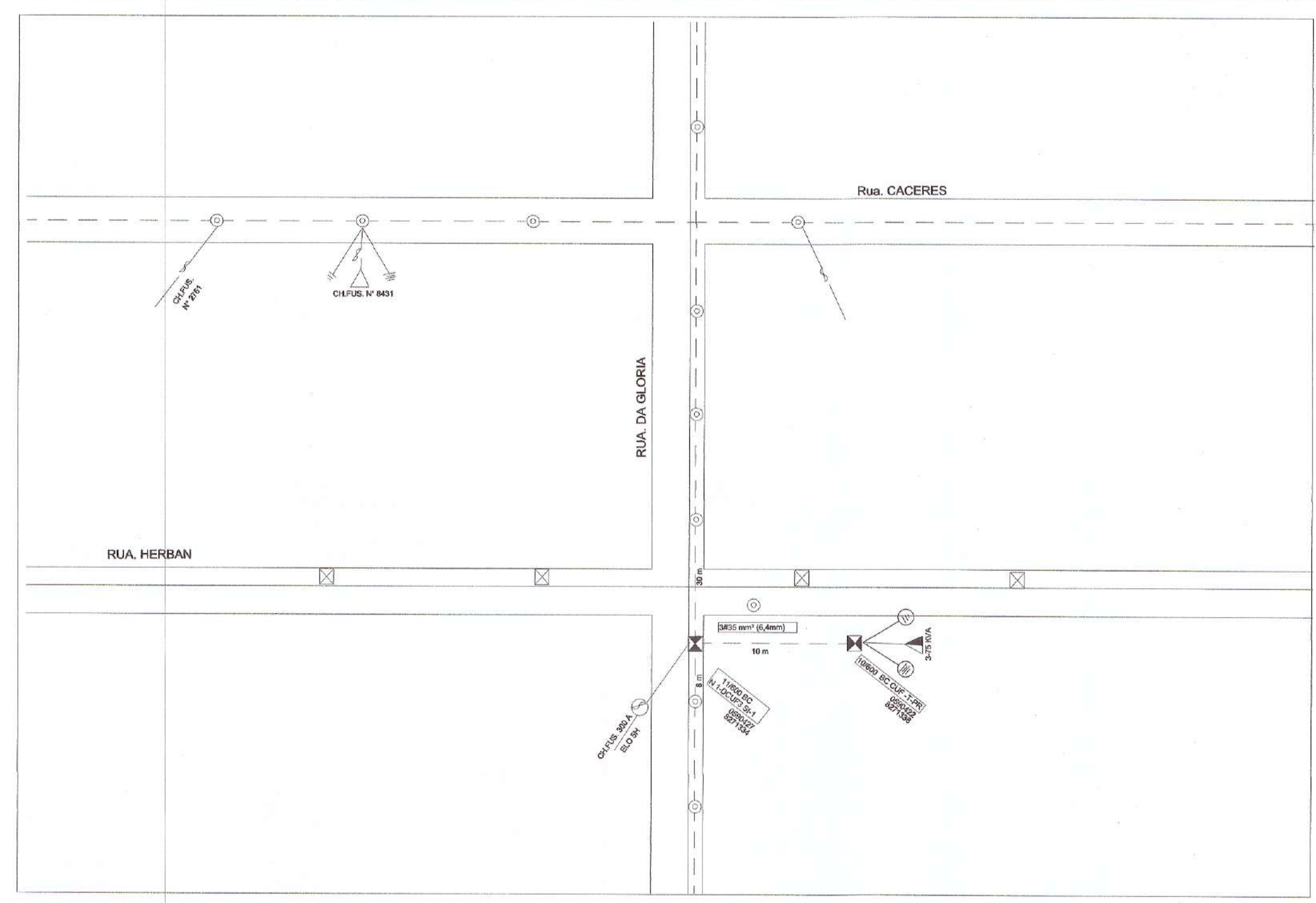

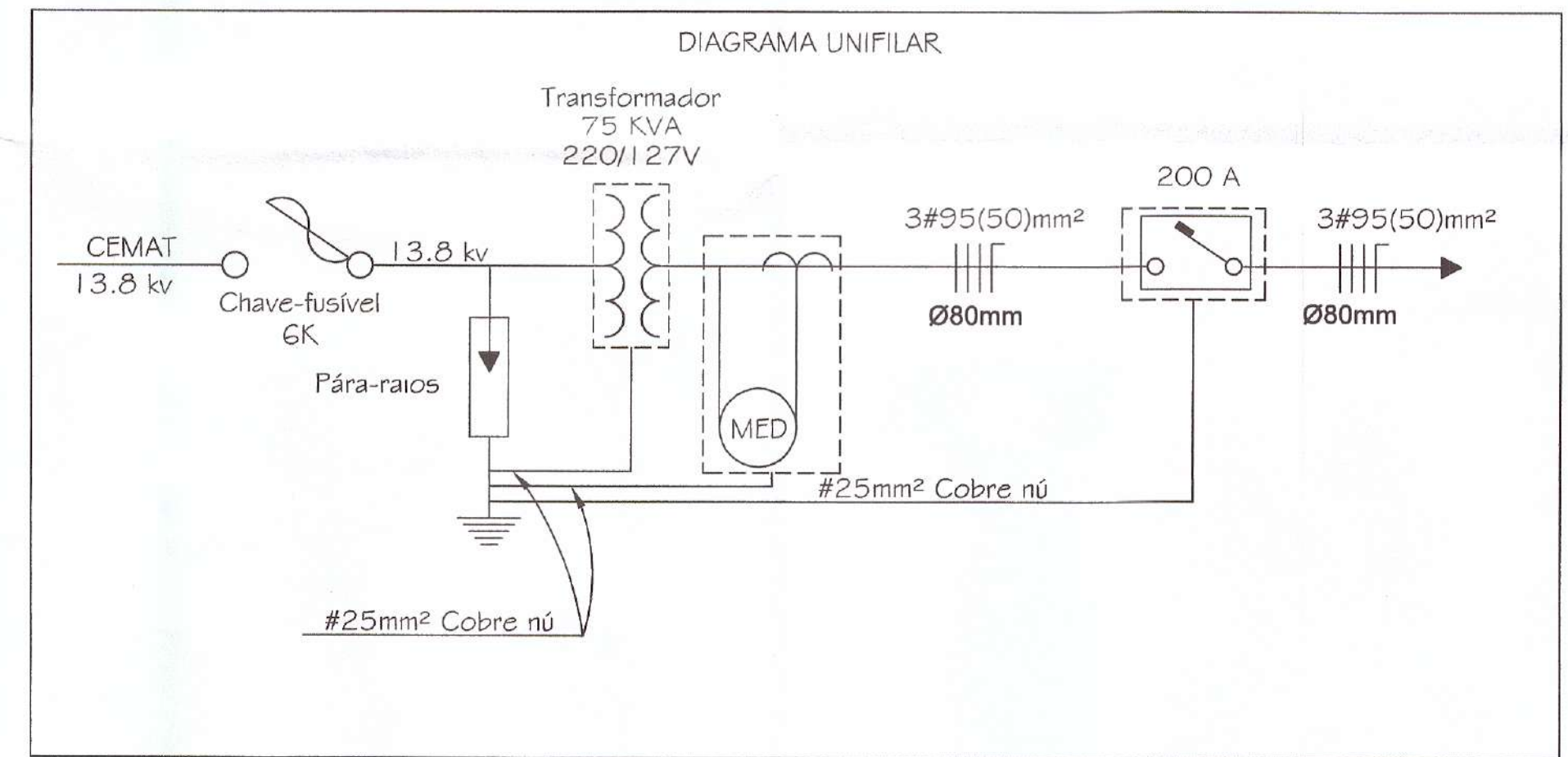

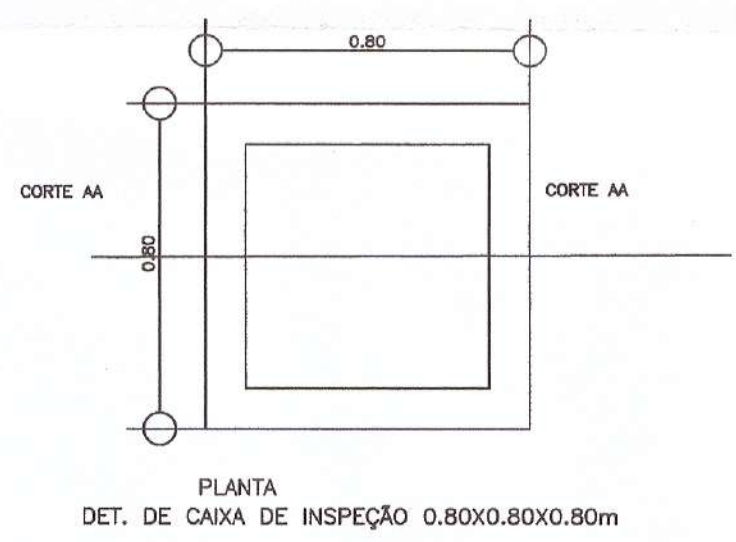

LEGENDA	
	Poste Circular instalado
	Poste Circular a instalar
	Poste Duplo "T" instalado Concreto
	Poste Duplo "T" a instalar
	Transformador instalado
	Transformador a instalar
	Chave Elo-Fusível instalada
	Chave Elo-Fusível a instalar
	Para-raio a instalar
	Para-raio instalado
	Aterramento a instalar
	Aterramento instalado
	Rede de Baixa Tensão
	Rede de Alta Tensão
	N1 Estrutura Existente
	Estrutura a ser Retirada
	(N1) Estrutura a ser Instalada
	11/300 Indicação a Altura e Esforço do Poste
	Quadro Geral de Distribuição

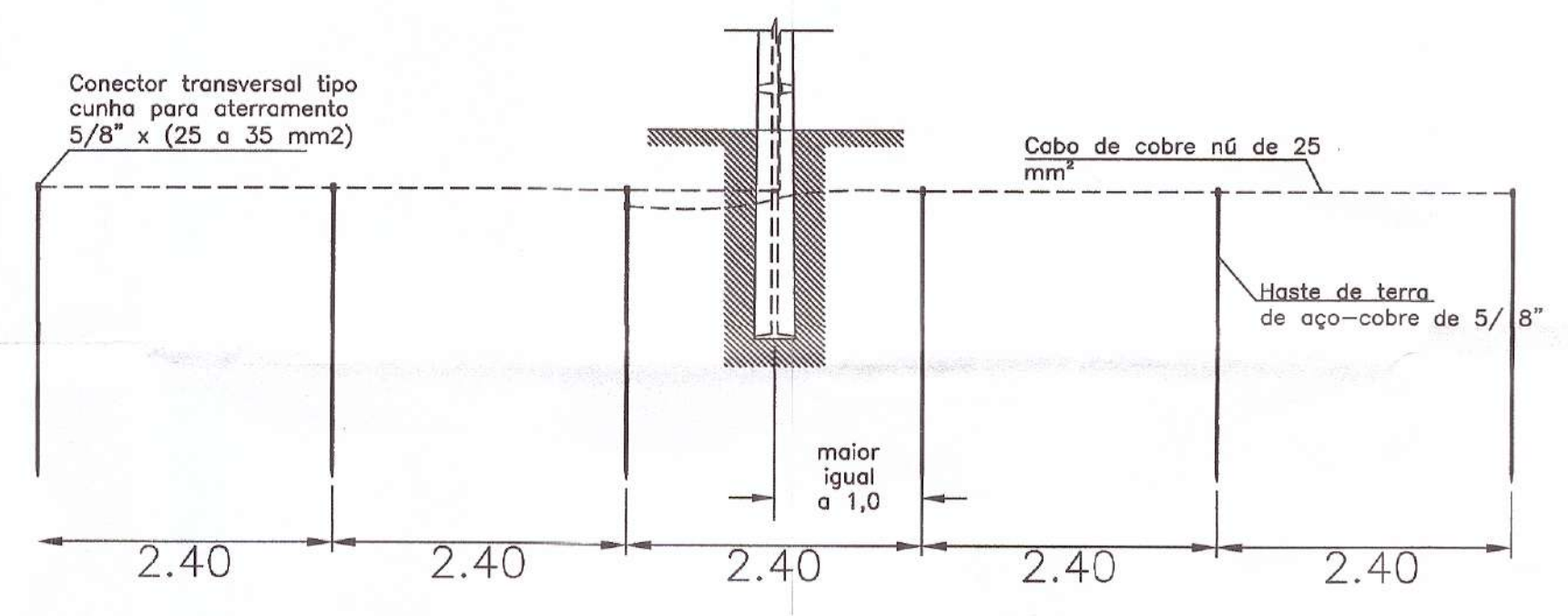

DETALHE MALHA DE ATERRAMENTO

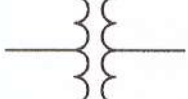

LEGENDA DIAGRAMA UNIFILAR					
	Chave-fusível		Transformador de corrente		Disjuntor BT
	Pára-raios		Transformador		Terra
	Medidor				

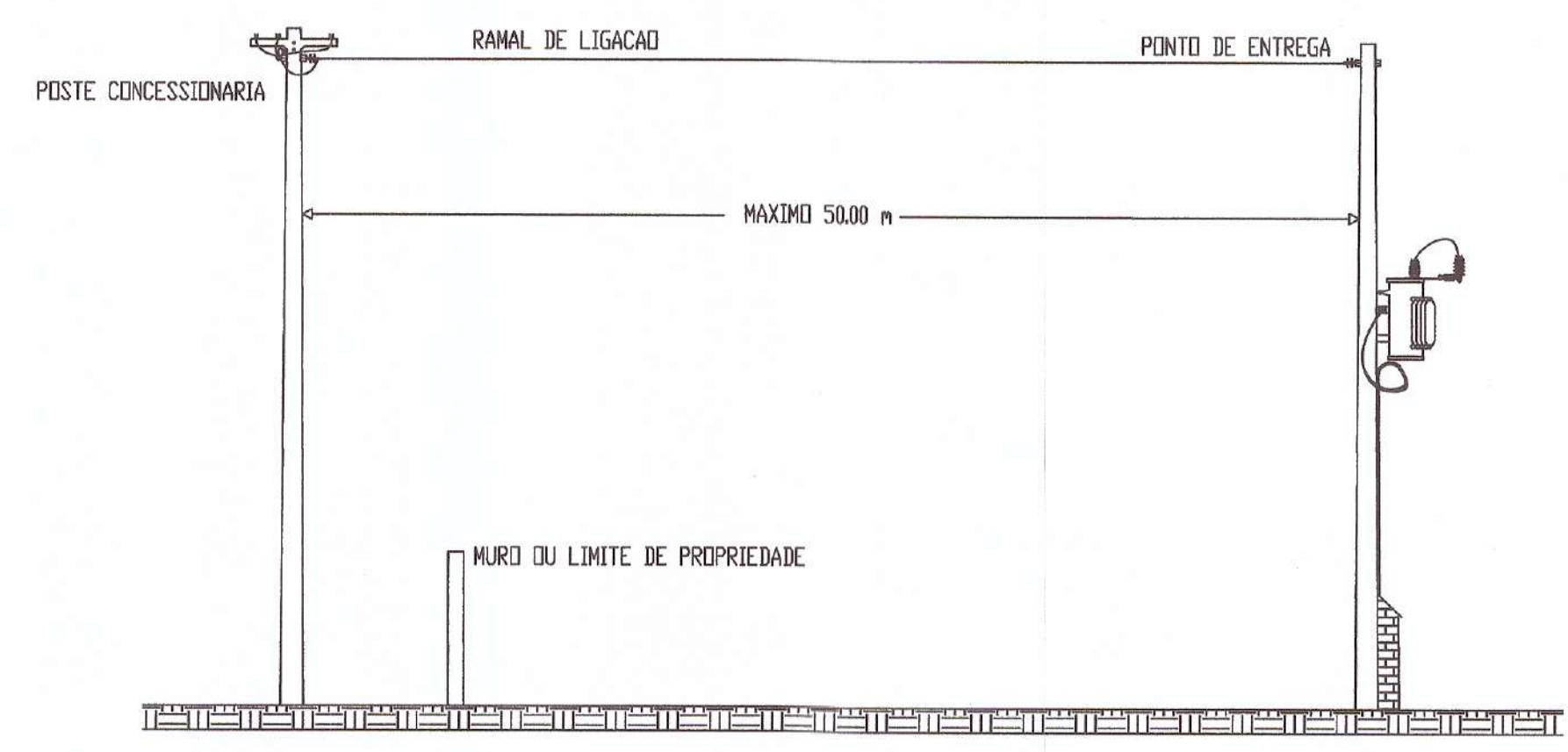
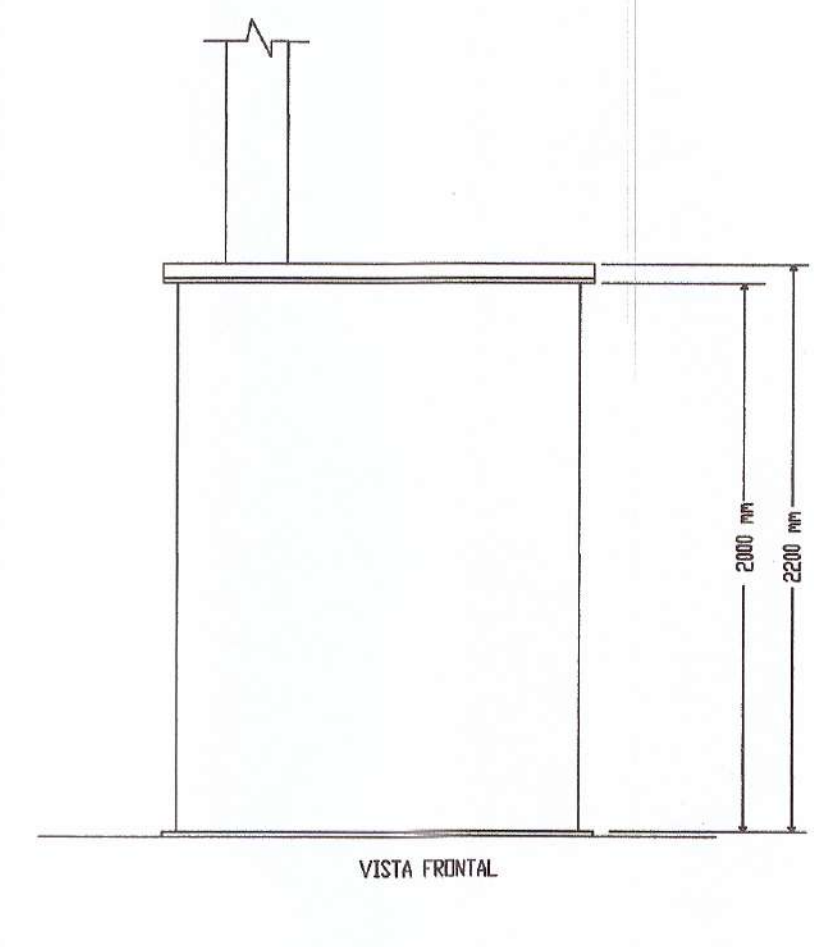
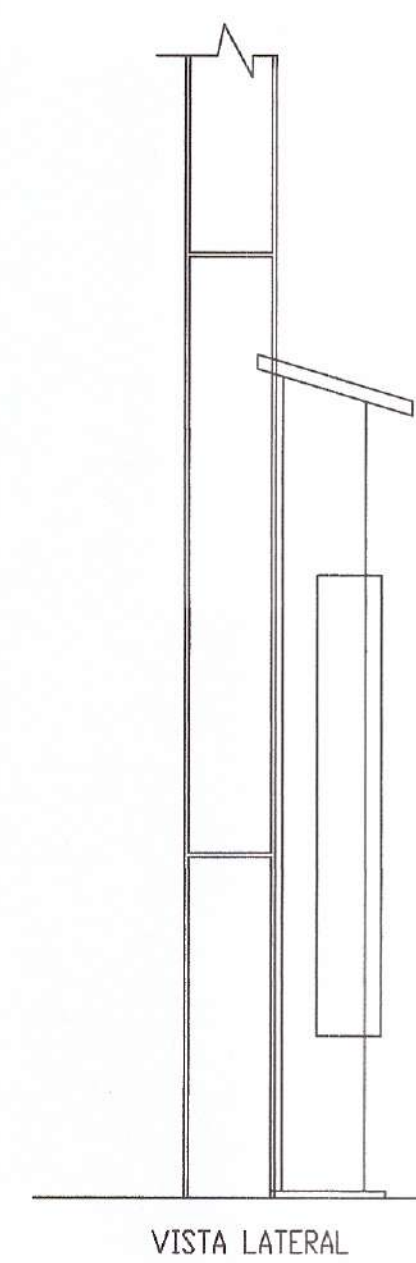
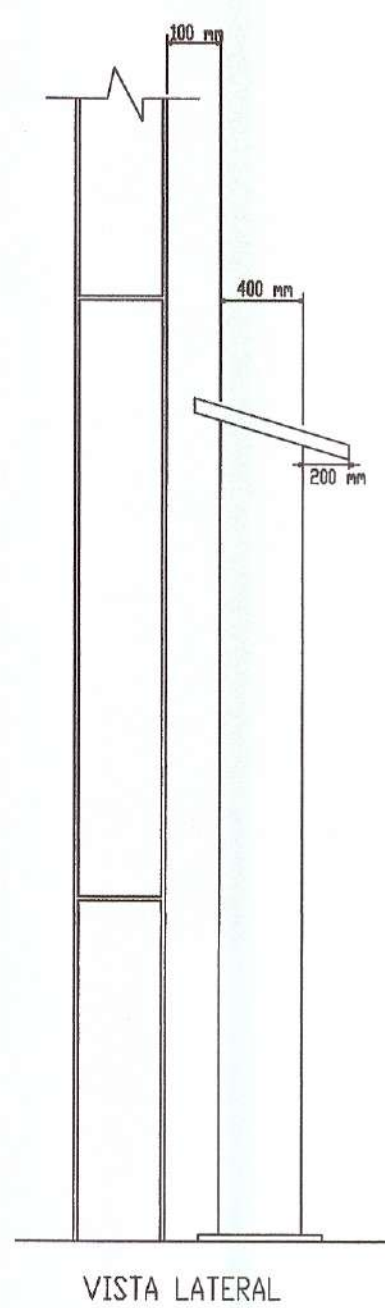
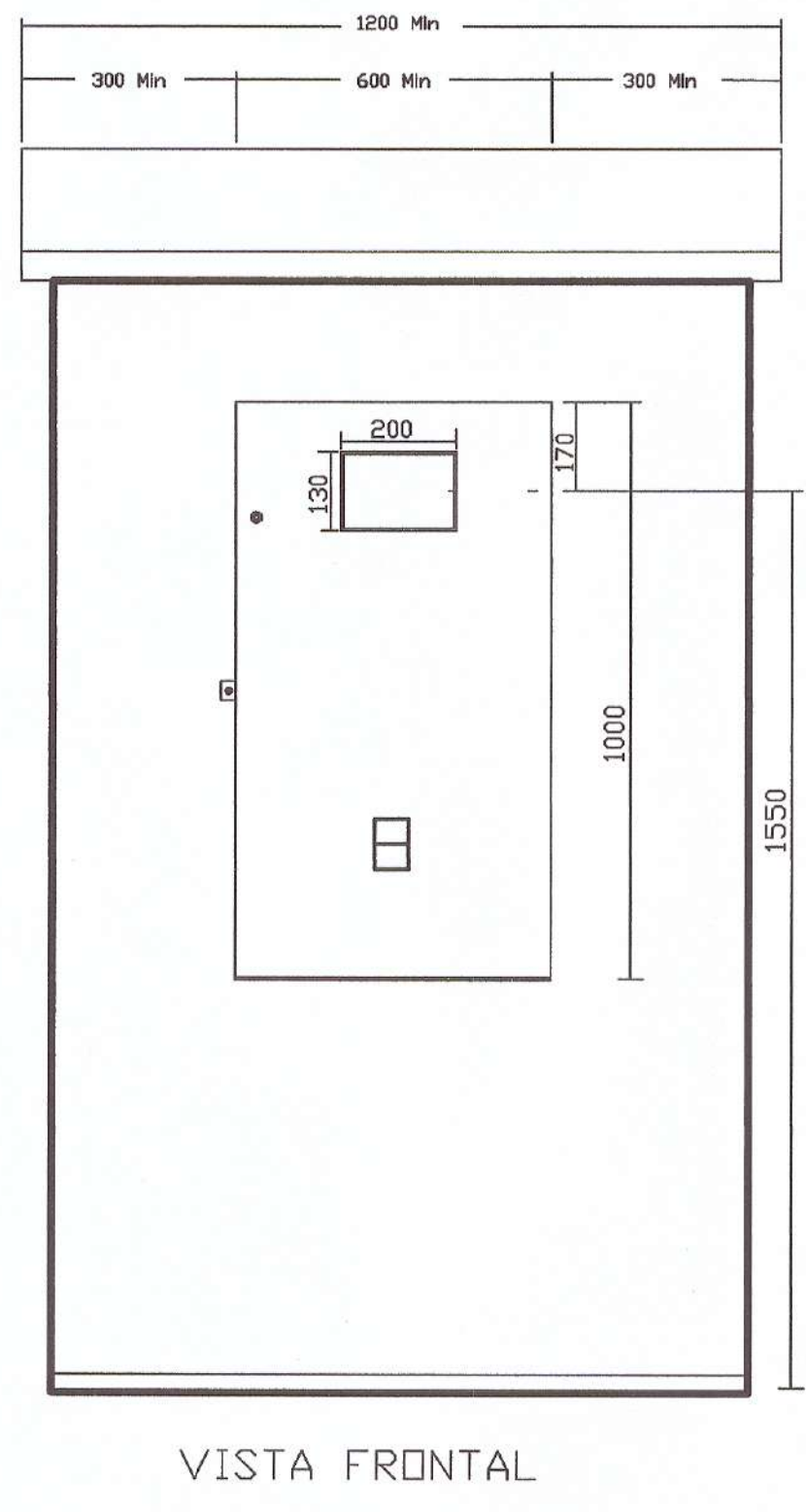

Schuring & Schuring Ltda.
Escritório Técnico B.E.SCHURING - Projetos Estruturais
Av. XV de Novembro, 489 - Porto 2o. Andar - Curitiba MT
Fone:(066) 3321 9958 - Fax:(066) 3823 5068 - Internet: Email - schuring@schuring.com.br

E.M.E.B PAULO FREIRE

OBRA: **PROJETO ELÉTRICO**

PROPRIETÁRIO PREFEITURA MUNICIPAL DE VÁRZEA GRANDE
CNPJ: 03.507.548/0001-10

LOCALIZAÇÃO
**RUA: HERBAN
BAIRRO: JARDIM GLORIA II
Várzea Grande/MT**

AUTOR DO PROJETO:
José Carlos Lima Fernandes
Eng. Elet. e Segurança do Trabalho
CONFEA 12010438/95

ASSUNTO / CONTEÚDO
**PROJETO DE REDE DISTRIBUICAO URBANA
COM INSTALACAO DE POSTO DE TRANSFORMACAO
DE 75 KVA-13,8 KV-220 / 127 V**

ESCALA
INDICADA

DATA

01/02